

PULSE EQUALIZER

MODEL **DVF-2**

WADECO

This device divides the number on any stream of input pulses in two and outputs pulses with equal periods of ON and OFF.

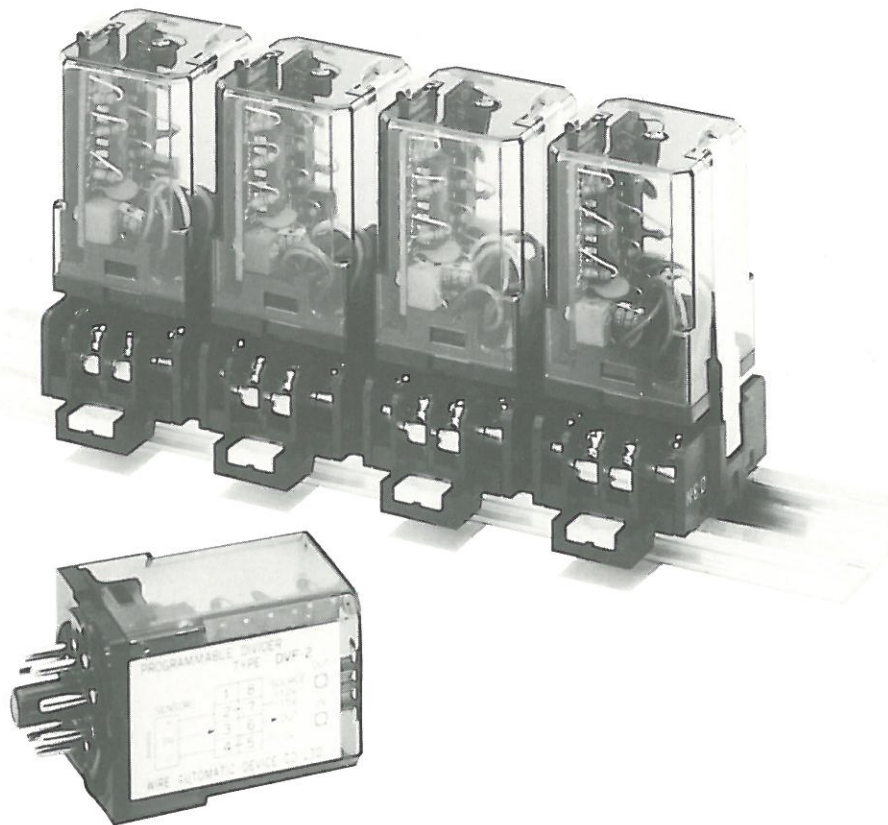

Introduction

The DVF-2 Pulse Equalizer receives pulses from a pulse generator and then outputs half the number of pulses with equal periods of ON and OFF.

Therefore this can be used when the ON or OFF period of the pulse is not sufficiently long enough to drive a counter.

Input pulses 

Output pulses 

Special Features

- The presence of input or output pulses is readily seen on the indications.
- Compact and rail mounted type.

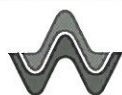

WIRE AUTOMATIC DEVICE CO., LTD.

PULSE EQUALIZER

Specifications

Type:	Pulse Equalizer DVF-2
Power supply:	DC12 ~ 15V
Power consumption:	12mA
Input:	Non-contact pulse input. Input by means of "H" (high) and "L" (low) input signal voltages.
Output:	Non-contact pulse output. Output by means of "H" (high) and "L" (low) output signal voltages.
Response frequency:	5kHz
Dividing ratio:	1/2 (fixed)
Ambient temperature:	-10°C ~ +50°C
Weight:	Pulse Equalizer 40g Socket 50g

Connection

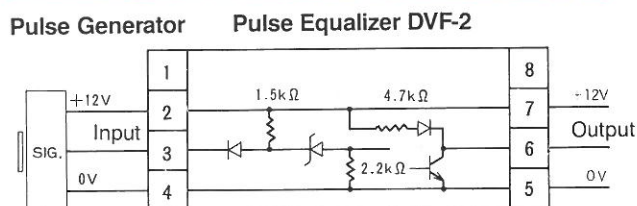

External Dimensions

**Pulse Equalizer
Type DVF-2**

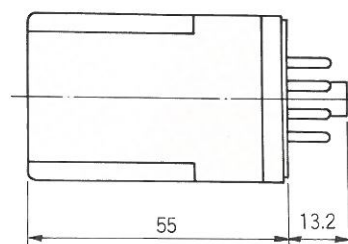
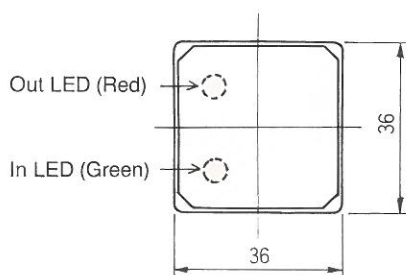

**Socket with metal fastening clips
Type TP38X**

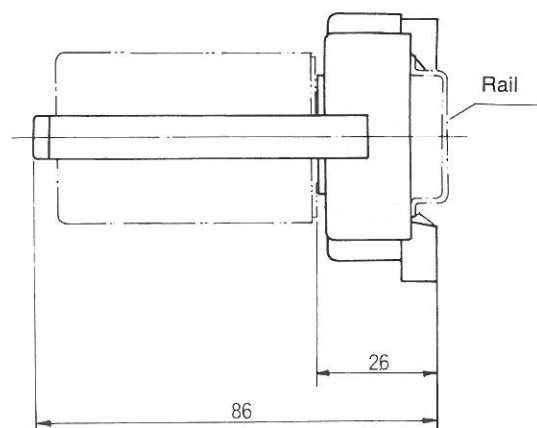
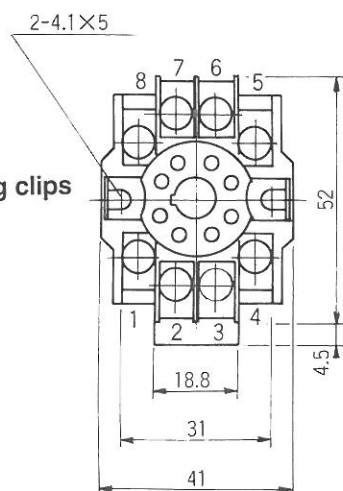

This specification may be changed without notification.