

920i®

Programmable HMI Indicator/Controller

Specifications

Power:

Line voltages: 230VAC
Frequency: 50 or 60 Hz
Power consumption: 340 mA, maximum 240 mA at 230VAC (26W)

Excitation Voltage:

10 ± VDC, 16 x 350 Ω or 32 x 700 Ω load cells per A/D card

Analog Signal Input Range:

-10 to 45 mV

Analog Signal Sensitivity:

0,3 µV/graduation minimum at 7,5 Hz
1,0 µV/graduation typical at 120 Hz
4,0 µV/graduation typical at 960 Hz

A/D Sample Rate:

7,5 to 960 Hz, software selectable

Resolution:

Internal resolution: 8 million counts
Weight display resolution: 9.999.999

System Linearity:

± 0,01% full scale

Digital I/O:

Six I/O channels on CPU board; optional 24-channel I/O expansion boards available

Circuit Protection:

RFI, EMI, ESD protection

Serial Ports:

Four ports on CPU board support up to 115.200 bps; optional dual-channel serial expansion boards available
Port 1: full duplex RS-232
Port 2: RS-232 with CTS/RTS; PS/2 keyboard interface via DB-9 connector
Port 3: full duplex RS-232, 20 mA output
Port 4: full duplex RS-232, two-wire RS-485, 20 mA output

Display (W x H):

116 x 86 mm, 320 x 240 pixel VGA Liquid Crystal Display (LCD) module with adjustable contrast. Transmissive display, standard. Transflective display option.

Keyboard:

27-key membrane panel, tactile feel, PS/2 port for external keyboard connection

Operating Temperature:

Legal: -10° C to 4° C
Industrial: -10° C to 50° C

Weight:

Universal enclosure: 4 kg
Wall mount enclosure: 10 kg
Panel mount enclosure: 4 kg
Deep universal: 5 kg

Rating/Material:

NEMA 4X/IP66, stainless steel

Warranty:

Two-year limited warranty

Approvals:

OIML approved 6.000/10.000, UK 2658
CE marked
Custom wall mount approved for 508A (optional)
Panel Mount UL recognized



Deep Universal



Universal



Panel Mount



Wall Mount

Approvals



Standard Features

- Large (L x H) 117 x 86 mm, 320 x 240 pixel backlit LCD graphical display
- Selectable character sizes from 6 to 31 mm
- 60 configurable operator prompts
- Display up to four scale channels per screen with required Legal for Trade information
- 32 scale accumulators
- Five soft keys with 10 user-defined, 14 preset functions per screen
- Ten programmable display screens
- Millivolt calibration, 5-point linearization and geographical calibration
- NEMA 4X/IP66 stainless steel enclosure
- Selectable A/D measurement rate up to 960/second
- 100 setpoints, 30 configurable setpoint types
- Two slots for option cards
- 1.000-ID truck register for in/out weighing
- 64K user on-board NV RAM
- User programmable 128K flash memory
- Reflash memory to upgrade firmware
- Power for 16, 350 ohms load cells per A/D board
- Local-remote indicators
- Multi range/interval
- Alibi storage
- Audit trail tracking
- Peak hold
- Rate of change

920i®

Programmable HMI Indicator/Controller

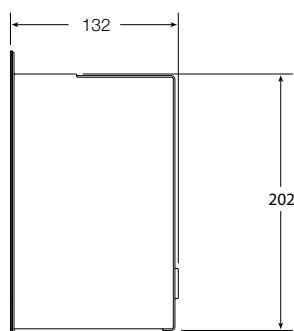
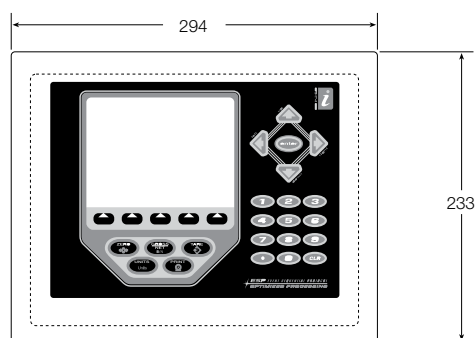
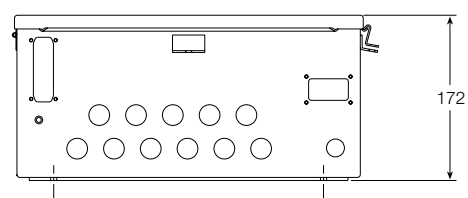
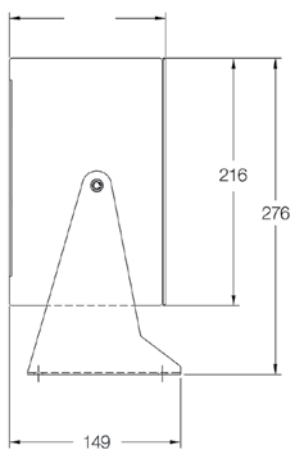
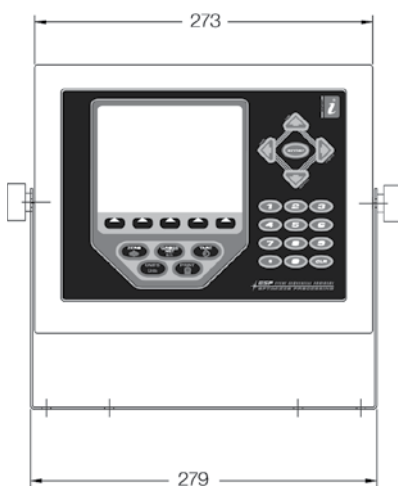
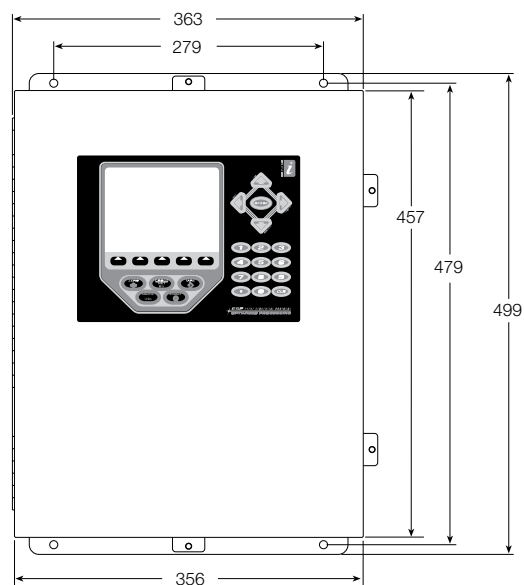
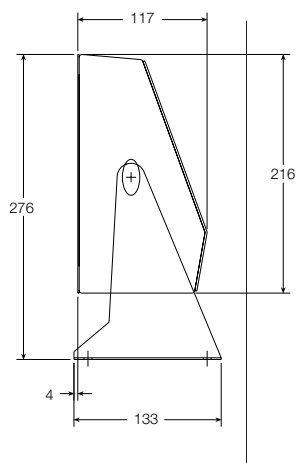
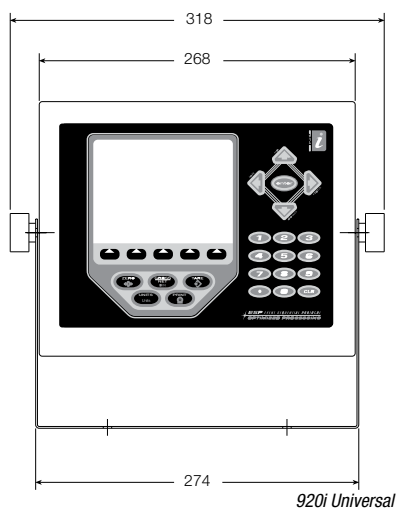

CONTROLLERS/INDICATORS

www.ricelake.eu | Phone: +31 (0) 26 472 1319

RICE LAKE

Part Numbers

PART #	DESCRIPTION	EST. SHIP WEIGHT
Single Channel - 230 VAC with Euro plug		
69522	920i Universal	4,5 kg
82459	920i Deep Universal	5,4 kg
72133	920i Wall Mount	10,4 kg
72137	920i Panel Mount	4 kg
Single Channel - 9-36 VDC		
107713	920i Universal, 25 watt	4,5 kg
107714	920i Deep Universal, 25 watt	5,4 kg
107715	920i Wall Mount, 25 watt	10,4 kg
107716	920i Panel Mount, 25 watt	4 kg
Dual Channel - 230 VAC with Euro plug		
69774	920i Universal	4,5 kg
82460	920i Deep Universal	5,4 kg
72134	920i Wall Mount	10,4 kg
72138	920i Panel Mount	4 kg
No A-D Channel - 230 VAC		
77791	920i Universal, without A/D	4,5 kg
93244	920i Deep Universal, without A/D	5,4 kg
77795	920i Wall Mount, without A/D	10,4 kg
77793	920i Panel Mount, without A/D	4 kg



CEE 7/7 plug

Options/Accessories

PART #	DESCRIPTION
Option Cards	
68532	A/D, single channel
68533	A/D, dual channel
67600	Memory, 1 MB NV RAM
67601	Digital I/O, 24-channel TTL output
67602	Analog output: selectable 0-10V, 0-20 mA
103138	Analog output, dual channel 0-10V, 0-20 mA
67603	Pulse input, single channel
67604	Serial port card, dual channel, RS-232 and RS-485
87697	Analog input ± 10 VDC, 0-20 mA and thermocouple
Network Cards	
65383	Ethernet thin server (external)
71986	Ethernet TCP/IP 10/100 base-T module (internal)
98057	Ethernet TCP/IP, wireless LAN card 802.11 B/G
87803	EtherNet/IP® (specifically for A-B PLC)
68539	Allen-Bradley® remote I/O interface (limited supply)
68540	Profibus® DP interface
68541	DeviceNet™ interface
103136	ControlNet interface
Expansion Cards	
69782	Two-slot expansion board (wall mount)
71743	Two-slot expansion board (panel mount and deep universal)
69783	Six-slot expansion board (wall mount)
Hardware	
154077	Scanner, DS457-SR, RS-232, requires power source
83569	Clear protective overlay (package of five)
70056	Cable, DB9M to DB9F, straight cable
93359	PS/2 keyboard
77788	Fiber optic board, installed in 920i
92777	Filter, PreVent™ vent kit PG 7 cord grip
100759	Sunlight viewable display, transfective installed option, replaces transmissive display
Manuals and Software	
69781	iRev™ scale software
72809	920i interchange® database software
67887	Additional installation manual
67888	Additional programming reference
Primary Component Parts	
117930	CPU board assembly
164371	Display board assembly transmission blue
164375	Display board assembly, transfective gray, sunlight viewable
67613	Power supply assembly, 25 watt
71333	Power supply, 65 watt used in deep, panel mount and wall enclosures
97474	DC/DC converter 9-36 nominal, 25 watt
66502	Switch panel membrane

Grayhill Relays and Racks

PART #	DESCRIPTION
52332	Two-channel input relay, 2.5-28VDC
52319	Two-channel input relay, 240VAC
52331	Two-channel input relay, 10-32VDC
52316	Two-channel output relay, 120-140VAC at 2 amp
52317	Two-channel output relay, 240-280VAC at 7 amp
71376	Two-channel output relay, 3-60VDC at 1 amp
71377	Two-channel output relay, 0-200VDC/VAC at 1,5A/10W (dry contact)
52331	Two-channel input relay, 10-32VDC
84698	Two-channel output relay, inductive load, 120-140VAC at 2A
84699	Two-channel output relay, inductive load, 240-280VAC at 2A
52312	Eight-channel relay rack, panel mount and wall mount, requires 50-Pin flat or round ribbon cable - four slots
52314	16-channel relay rack, panel mount and wall mount, requires 50-Pin flat or round ribbon cable - eight slots
52315	24-channel relay rack, panel mount and wall mount, requires 50-Pin flat or round ribbon cable - 12 slots
76644	Eight-channel relay rack, DIN rail mount, requires 50-Pin flat or round ribbon cable - four slots
76645	16-channel relay rack, DIN rail mount, requires 50-Pin flat or round ribbon cable - eight slots
76646	24-channel relay rack, DIN rail mount requires 50-Pin flat or round ribbon cable - 12 slots
46189	Jumper strap, 10 position for Grayhill
108396	Digital input 5VDC, 15-30VAC/10-32VDC
108397	Digital output 5VDC, 3-60VDC
70780	Cable, 50-Pin flat ribbon for digital I/O
70779	Cable, 50-Pin round ribbon for digital I/O with cord grip
72442	Cable, 50-Pin round ribbon for digital I/O without cord grip

OPTO 22 Relays and Racks

PART #	DESCRIPTION
15969	G4IDC5 10-32VDC input relay module, white (N/O)
15970	G40DC5R dry contact 100VDC/1,5A output, red (N/O)
22848	G40DC5R5 dry contact 100VDC/1,5A output, red (N/C)
15971	G40AC5 115VAC output relay module, black (N/O)
15972	G4IAC5 115VAC input relay module, yellow (N/O)
22847	G40AC5A5 115/230VAC output relay module, black (N/C)
36632	G40AC5A 115/230VAC output relay module, black (N/O)
36631	G4IAC5A 230VAC input relay module, yellow (N/O)
16478	Quencharc arc suppressor
15973	Four-channel relay rack, 83 x 83 mm
99032	Adapter plate, for four-channel Opto rack 33490
54215	Fuse, 3,15 amp, Grayhill
26834	Fuse, 1 amp, OPTO 22
21735	Fuse, 4 amp, OPTO 22